

Eastlinks Business Park



Eastlinks IV

12550 Professional Park Drive
Fort Myers, Florida

- Two 29,925 sq. ft. office buildings separated by a courtyard with park-like landscaping
- Suites from 1,300 square feet with individual entrances
- Ample parking with curbs and lighting
- Professionally maintained landscaping
- Seven building, office and flex park located at the intersection of Daniels Parkway and Gateway Boulevard
- In close proximity to I-75 and Southwest Florida International Airport
- Full service design and construction with generous build-out allowance

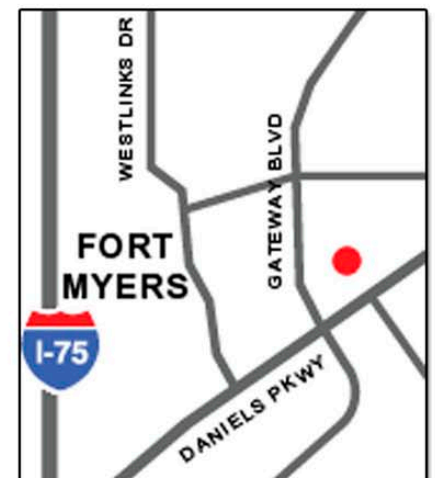

239.738.7900
leasing@mcgarveydevelopment.com

Broker Participation Encouraged
www.mcgareveydevelopment.com



Eastlinks IV

Floor Plan

Building A

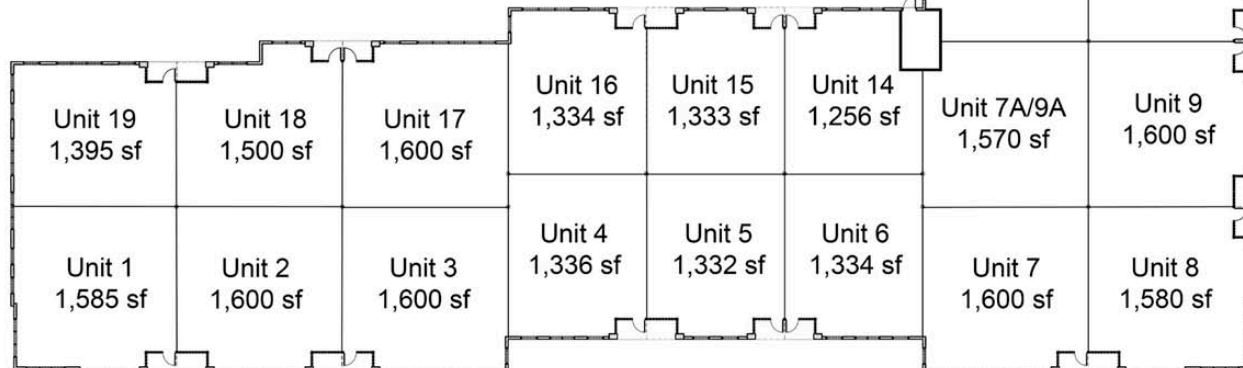
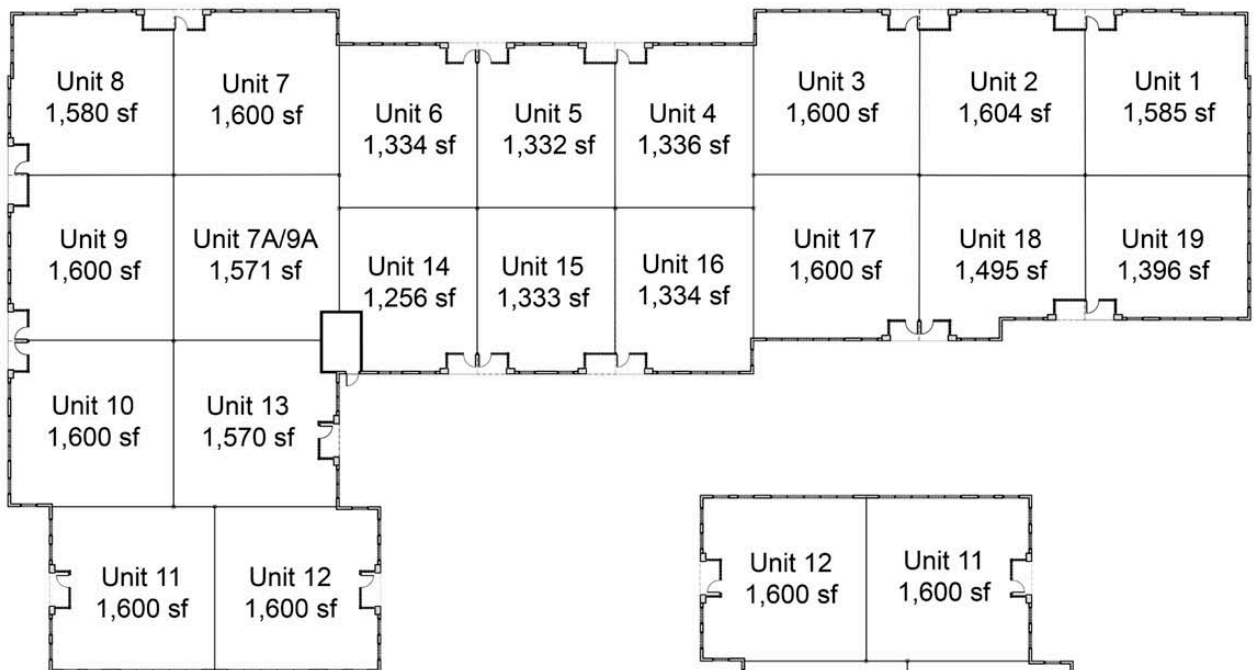

Building B